

**POPULAR MODEL**

## VERNIER DEPTH GAUGES (STANDARD TYPE)

- Made of stainless steel
- Satin chrome plated reading surface



1240-2001

### Graduation 0.05mm

| Code     | Range   | Accuracy | L     | d     | c    |
|----------|---------|----------|-------|-------|------|
| 1240-150 | 0-150mm | ±0.05mm  | 250mm | 100mm | 10mm |
| 1240-200 | 0-200mm | ±0.05mm  | 300mm | 100mm | 10mm |
| 1240-300 | 0-300mm | ±0.08mm  | 400mm | 100mm | 10mm |
| 1240-500 | 0-500mm | ±0.09mm  | 605mm | 150mm | 11mm |

### Graduation 0.02mm

| Code      | Range   | Accuracy | L               | d     | c         |         |         |       |       |      |           |         |         |       |       |      |
|-----------|---------|----------|-----------------|-------|-----------|---------|---------|-------|-------|------|-----------|---------|---------|-------|-------|------|
| 1240-1501 | 0-150mm | ±0.03mm  | 250mm           | 100mm | 10mm      |         |         |       |       |      |           |         |         |       |       |      |
| 1240-2001 | 0-200mm | ±0.03mm  | 300mm <td 100mm | 10mm  | 1240-3001 | 0-300mm | ±0.04mm | 400mm | 100mm | 10mm | 1240-5001 | 0-500mm | ±0.05mm | 605mm | 150mm | 11mm |
| 1240-3001 | 0-300mm | ±0.04mm  | 400mm           | 100mm | 10mm      |         |         |       |       |      |           |         |         |       |       |      |
| 1240-5001 | 0-500mm | ±0.05mm  | 605mm           | 150mm | 11mm      |         |         |       |       |      |           |         |         |       |       |      |

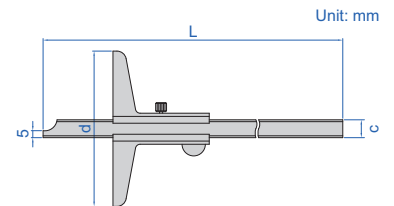

**WITH MOUNTING HOLES FOR EXTENSION BASE**

## VERNIER DEPTH GAUGES



1247-2001

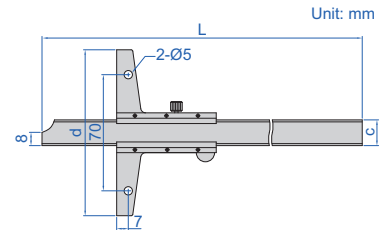

- Made of stainless steel
- Satin chrome plating finish on reading surface
- Optional accessory: extension base (code 6141)

extension base (optional)



| Range    | L      | c    | d     |
|----------|--------|------|-------|
| 0-150mm  | 240mm  | 16mm | 100mm |
| 0-200mm  | 290mm  | 16mm | 100mm |
| 0-300mm  | 390mm  | 16mm | 100mm |
| 0-600mm  | 704mm  | 16mm | 150mm |
| 0-1000mm | 1140mm | 16mm | 200mm |

| Code      | Range    | Accuracy | Graduation |
|-----------|----------|----------|------------|
| 1247-150  | 0-150mm  | ±0.05mm  | 0.05mm     |
| 1247-200  | 0-200mm  | ±0.05mm  | 0.05mm     |
| 1247-300  | 0-300mm  | ±0.08mm  | 0.05mm     |
| 1247-600  | 0-600mm  | ±0.10mm  | 0.05mm     |
| 1247-1000 | 0-1000mm | ±0.15mm  | 0.05mm     |

| Code      | Range    | Accuracy | Graduation |
|-----------|----------|----------|------------|
| 1247-1501 | 0-150mm  | ±0.03mm  | 0.02mm     |
| 1247-2001 | 0-200mm  | ±0.03mm  | 0.02mm     |
| 1247-3001 | 0-300mm  | ±0.04mm  | 0.02mm     |
| 1247-6001 | 0-600mm  | ±0.05mm  | 0.02mm     |
| 1247-1001 | 0-1000mm | ±0.07mm  | 0.02mm     |

## VERNIER DEPTH GAUGES WITH FINE ADJUSTMENT

WITH MOUNTING HOLES FOR EXTENSION BASE



1249-1501

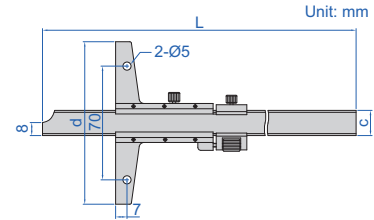

- With fine adjustment
- Made of stainless steel
- Satin chrome plating finish on reading surface
- Optional accessory: extension base (code **6141**)

extension base (optional)



### Graduation 0.02mm

| Code      | Range   | Accuracy |
|-----------|---------|----------|
| 1249-1501 | 0-150mm | ±0.03mm  |
| 1249-2001 | 0-200mm | ±0.03mm  |
| 1249-3001 | 0-300mm | ±0.04mm  |

### Graduation 0.05mm

| Code     | Range   | Accuracy |
|----------|---------|----------|
| 1249-150 | 0-150mm | ±0.05mm  |
| 1249-200 | 0-200mm | ±0.05mm  |
| 1249-300 | 0-300mm | ±0.08mm  |

| Range   | L     | c    | d     |
|---------|-------|------|-------|
| 0-150mm | 256mm | 16mm | 100mm |
| 0-200mm | 306mm | 16mm | 100mm |
| 0-300mm | 406mm | 16mm | 100mm |

## VERNIER HOOK DEPTH GAUGES

WITH MOUNTING HOLES FOR EXTENSION BASE

extension base (optional)



1248-1501

- Made of stainless steel
- Satin chrome plating finish on reading surface
- Optional accessory: extension base (code **6141**)

### Graduation 0.05mm

| Code     | Range   | Accuracy | L     |
|----------|---------|----------|-------|
| 1248-150 | 0-150mm | ±0.05mm  | 266mm |
| 1248-200 | 0-200mm | ±0.05mm  | 316mm |
| 1248-300 | 0-300mm | ±0.08mm  | 416mm |

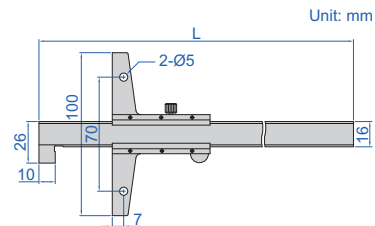

### Graduation 0.02mm

| Code      | Range   | Accuracy | L     |
|-----------|---------|----------|-------|
| 1248-1501 | 0-150mm | ±0.03mm  | 266mm |
| 1248-2001 | 0-200mm | ±0.03mm  | 316mm |
| 1248-3001 | 0-300mm | ±0.04mm  | 416mm |

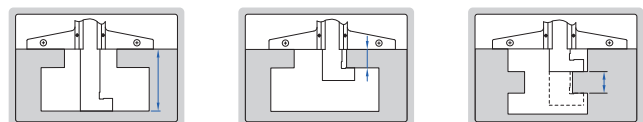

## VERNIER HOOK DEPTH GAUGE

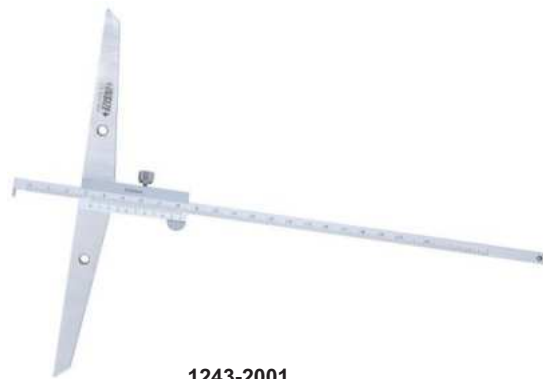

1243-2001

- Graduation 0.02mm
- Made of stainless steel
- Satin chrome plating finish on reading surface

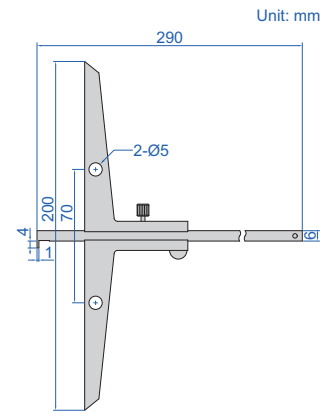

Unit: mm

| Code      | Range   | Accuracy |
|-----------|---------|----------|
| 1243-2001 | 0-200mm | ±0.04mm  |

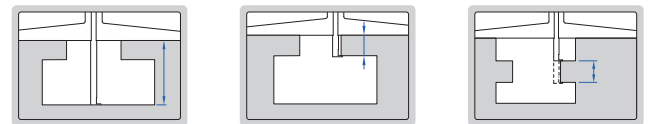

## EXTENSION BASES



6141-260

- Supplied with two screws
- Made of stainless steel
- Suitable for depth gauges series 1147, 1148, 1247, 1248 and 1249

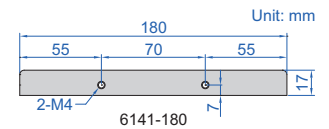

Unit: mm

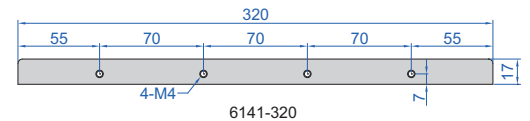
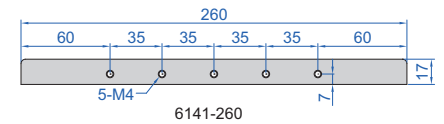
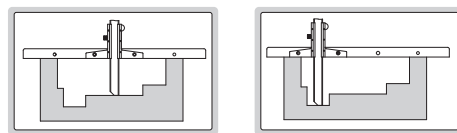

| Code     | Length |
|----------|--------|
| 6141-180 | 180mm  |
| 6141-260 | 260mm  |
| 6141-320 | 320mm  |
| 6141-600 | 600mm  |

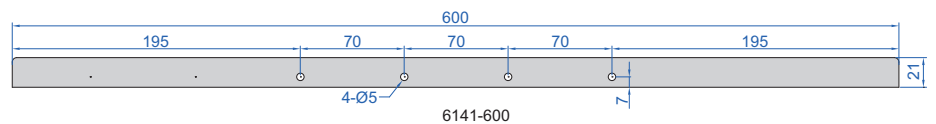

## MINI VERNIER DEPTH GAUGE

- Graduation: 0.1mm
- Made of stainless steel



1244-30

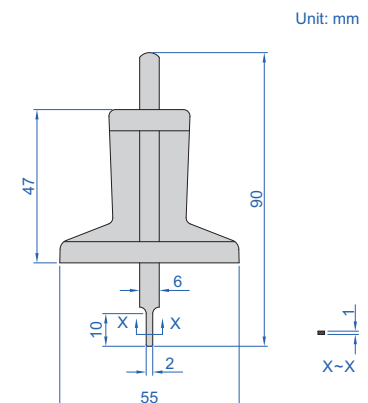

Unit: mm

| Code    | Range  | Accuracy |
|---------|--------|----------|
| 1244-30 | 0-30mm | ±0.10mm  |



DATA  
OUTPUT

## DIGITAL KEYWAY DEPTH GAUGE

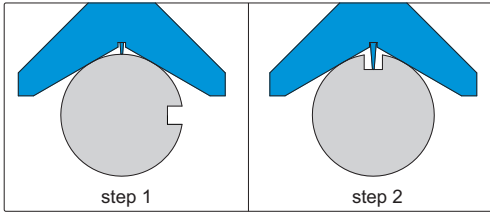

- Measure keyway depth of cylindrical workpieces with diameter  $\varnothing 10-100\text{mm}$
- Button function: on/off, zero, inch/metric conversion, absolute/incremental measurement, data preset, measuring direction change
- CR2032 battery, automatic power off (time is adjustable)
- Data output
- Stainless steel base
- Pointed tip
- Optional accessory:  
wireless transmitter code **7315-50M** (receiver is needed) page 6,  
bluetooth transmitter code **7214-50M** page 12,  
data output cable code **7302-40M** page 21



2182-25

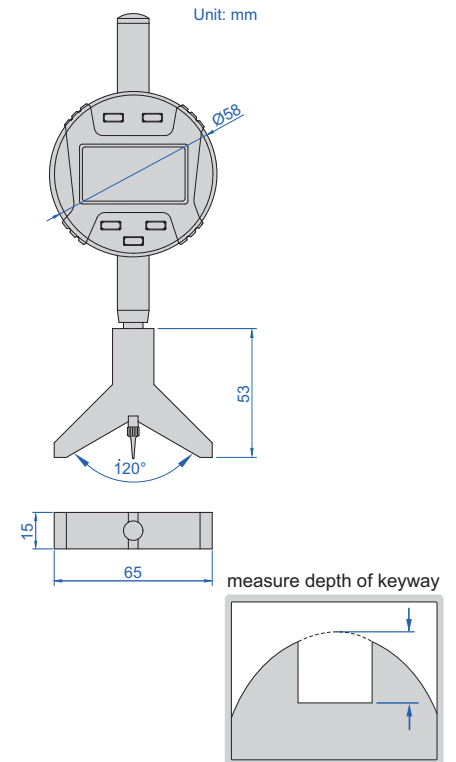

| Code    | Range         | Resolution     | Accuracy            |
|---------|---------------|----------------|---------------------|
| 2182-25 | 0-25.4mm/0-1" | 0.01mm/0.0005" | $\pm 0.02\text{mm}$ |

9



## DIAL KEYWAY DEPTH GAUGE

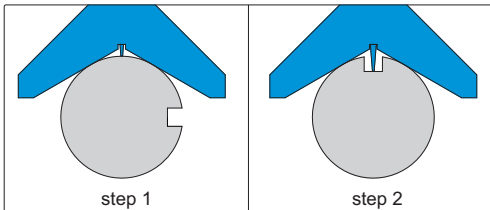

- Measure keyway depth of cylindrical workpieces with diameter  $\varnothing 10-100\text{mm}$
- Stainless steel base
- Pointed tip



2189-30

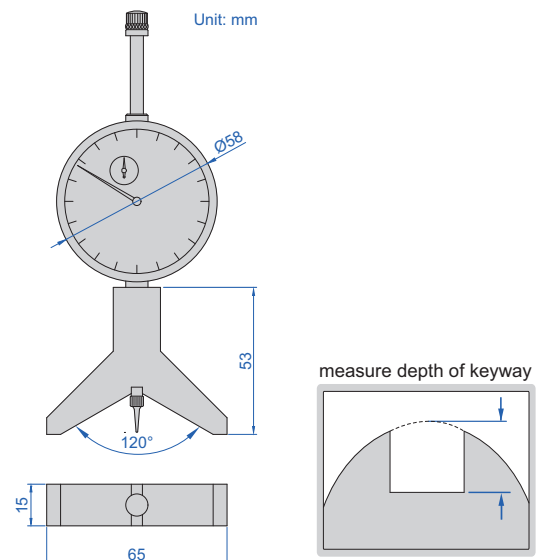

| Code    | Range  | Graduation | Accuracy            |
|---------|--------|------------|---------------------|
| 2189-30 | 0-30mm | 0.01mm     | $\pm 0.03\text{mm}$ |

measure width of keyway

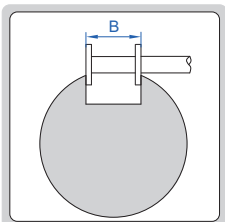

## GROOVE MICROMETERS



3287-50B

REFER TO PAGE 153  
FOR DETAILS